

Four Foot Module Cabinet (approximately to scale)

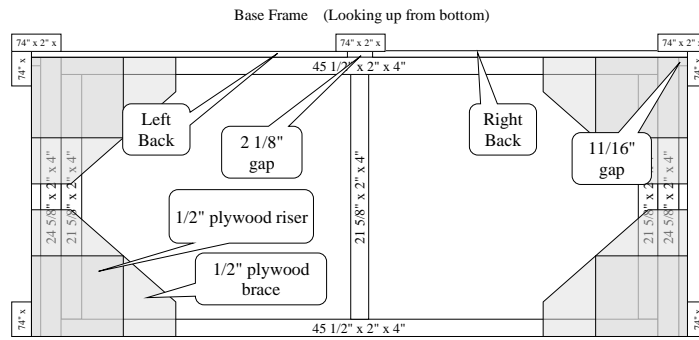

ASSEMBLY INSTRUCTIONS

- Step 1. Make all the cuts and sand all the parts.
- Step 2. Assemble the base frame. (Glue and screw all assemblies)
- Step 3. Assemble the two side panels except for the 24 5/8" 2" x 4" at the base. (Cut a 13 1/2" x 15 1/2" spacer jig from scrap plywood to help position and level the 2" x 4"s.)
- Step 4. Attach the sides to the base.
- Step 5. Lay the assembly on its face. Attach the 72 1/2" x 2" x 4" for the top frame, measuring diagonally to square the box. Then attach the 72 1/2" x 2" x 4"s for the middle frames. Attach the 2" x 2" and 2" x 4" center spreaders to the back 2" x 4"s.
- Step 6. Flip the assembly on its back, attach the front 72 1/2" 2" x 2"s and 2" x 4" and secure the center spreaders. Attach the front verticle 74" x 4"s to the sides.
- Step 7. Flip the assembly on its front. Attach the rear verticle 74" x 2" x 4"s to the sides.
- Step 8. Attach the back panels and then the roof panel. Attach the four 74" x 2" x 4"s to the back side.
- Step 9. Attach the plywood braces to the base, then attach the plywood risers to the braces. Paint the base. Attach the wheels. Paint the rest.
- Step 10. Attach the shelves. Then glue two 72" x 7/8" wide strips of 1/8" hardboard, laminated together, along the interior back wall, immediately above each masonite shelf.

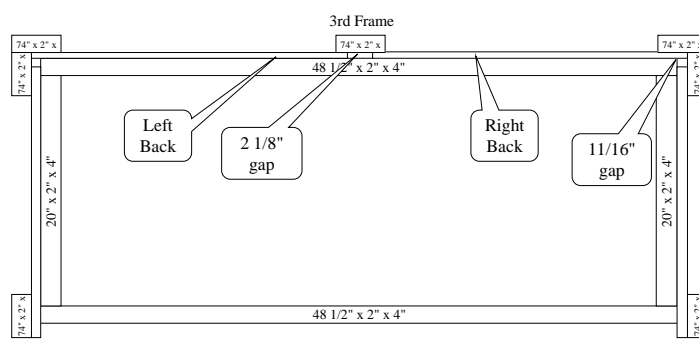
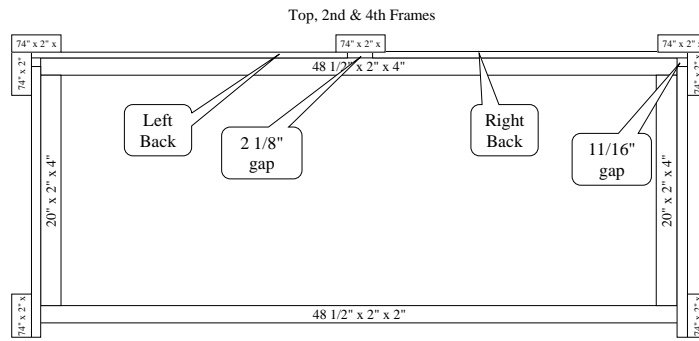
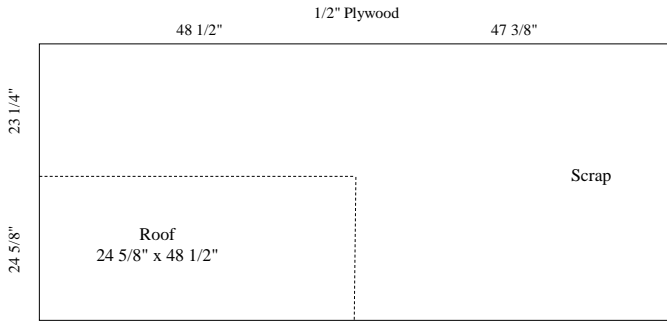
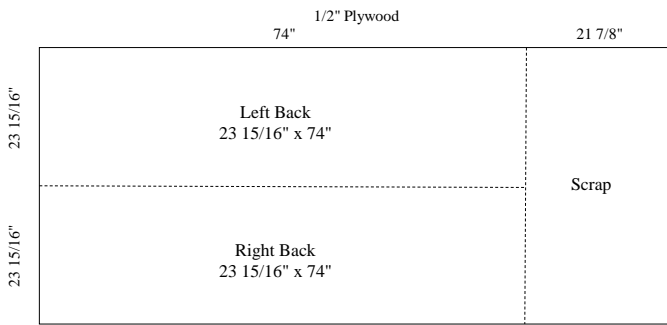
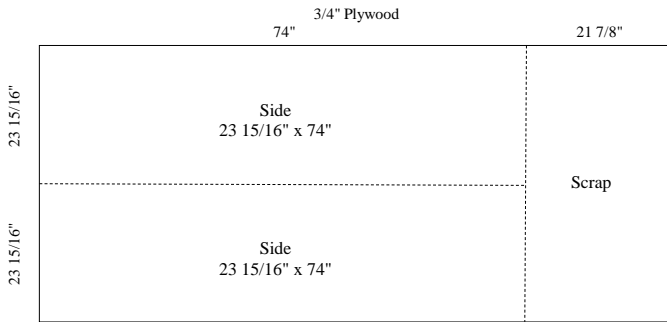
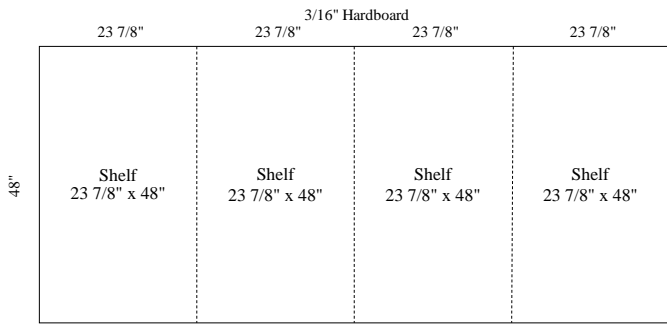
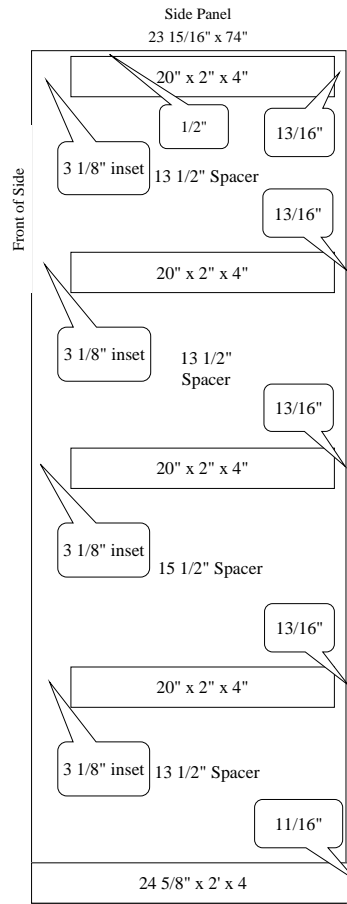

Brace & Riser Cuts (1/2" Plywood)

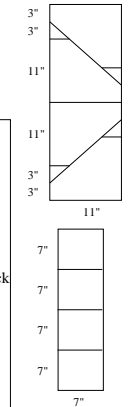

#	PARTS LIST	@	*	Σ
2	3/16" Hardboard 4' x 8'	\$	13.48	\$ 26.96
1	3/4" Plywood 4' x 8'	\$	20.57	\$ 20.57
2	1/2" Plywood 4' x 8'	\$	13.67	\$ 27.34
9	2" x 6" x 8'	\$	4.40	\$ -
17	2" x 4" x 8'	\$	2.62	\$ 44.54
	1" x 2" x 8'			\$ -
2	box 1 5/8" screws	\$	4.40	\$ 8.80
2	box 3" screws	\$	5.40	\$ 10.80
1/2	gal carpenter's glue	\$	16.00	\$ 8.00
3/4	gal paint	\$	-	\$ -
4	4" 330# offset wheels	\$	6.00	\$ 24.00
Total				\$ 171.01
* Prices at Home Depot on 1/15/12				Total w/ tax \$ 185.55

#	Stock	Cuts
8	2" x 4"	74"
5	2" x 4"	72 1/2"
2	2" x 4"	69 1/2"
9	2" x 4"	20"
3	2" x 4"	21 5/8"
2	2" x 4"	24 5/8"
3	2" x 2"	72 1/2"
3	2" x 2"	19"